

# **UNITED<sup>®</sup>**

## **INSTRUCTIONS MANUAL**

### **18" STAND FAN WITH REMOTE CONTROL**



**Model: USF-780/2**

**READ AND SAVE THESE INSTRUCTIONS**

## CAUTION

1. When using electrical appliances, basic precautions should always be followed to reduce the risk of fire, electric shock, and injury to persons, including the following:
2. To prevent fire or shock hazard, DO NOT expose this appliance to rain or moisture.
3. Dangerous high voltages are present inside this enclosure. To avoid electric shock, DO NOT open the cabinet, refer servicing to qualified personnel only.
4. This appliance is intended for household use only and not for commercial, industrial or outdoor use. Other use not recommended may cause fire, electric shock or injury.
5. Ensure the fan is not placed near drapes,curtains, or any objects that may be drawn into the fan.
6. To protect against fire, electrical shock and injury to persons, do not immerse the unit, plug or cord in water or spray it with liquids.
7. The apparatus shall not be exposed to dripping or splashing and no objects filled with liquids, such as vases, shall be placed on the product.
8. No naked flames sources, such as candles, should be placed on the product.
9. Ventilation should not be impeded by covering the ventilation openings. Slots and openings are provided for ventilation to ensure reliable operation of the product and to protect it from overheating.
10. Care required with the use of this apparatus in tropical climates. Do not use the appliance at temperatures above 40 °C.
11. Place the fan on a stable level and dry surface when operating to avoid overturning.
12. Only connect to a suitable AC 220-240V~50Hz mains socket.
13. Do not operate the fan in the presence of explosive and/ or flammable fumes. Do not place the fan or any parts near an open flame, cooking or other heating appliance.
14. Do not operate the fan with a damaged cord or plug, after a malfunction or if it is dropped or damaged in any manner.
15. Do not operate the fan without the fan grilles properly in place.
16. Do not place the fan close to an open window. Rain splashing on the fan could cause an electric shock hazard.
17. Do not let the power cord hang over the edge of a table or counter or let it touch any hot surfaces.
18. Do not insert or allow foreign objects to enter the grille openings as this may cause damage to the appliance.
19. Do not use the fan if the grille becomes damaged or loose.
20. This appliance can be used by children aged from 8 years and above and persons with reduced physical, sensory or mental capabilities or lack of experience and knowledge if they have been given supervision or instruction concerning the use of the appliance in a safe way and understand the hazards involved. Children shall not play with the appliance. Cleaning and user maintenance shall not be made by children without supervision.
21. Children of less than 3 years should be kept away unless continuously supervised. Children aged from 3 years and less than 8 years shall only switch on/off the appliance provided that it has been placed or installed in its intended normal operating position and they have been given supervision or instruction concerning use of the appliance in a safe way and understand the hazards involved. Children aged from 3 years and less than 8 years shall not plug in, regulate and clean the appliance or perform user maintenance.

22. Switch the fan OFF and unplug it from the outlet when it is not in use, when moving it from one location to another and before cleaning.
23. To disconnect, grip the plug and pull it from the wall outlet. Never pull by the cord.
24. Do not attempt to repair, disassemble or modify the appliance. There are no user-serviceable parts inside. Refer all servicing to qualified service personnel.

## INTRODUCTION

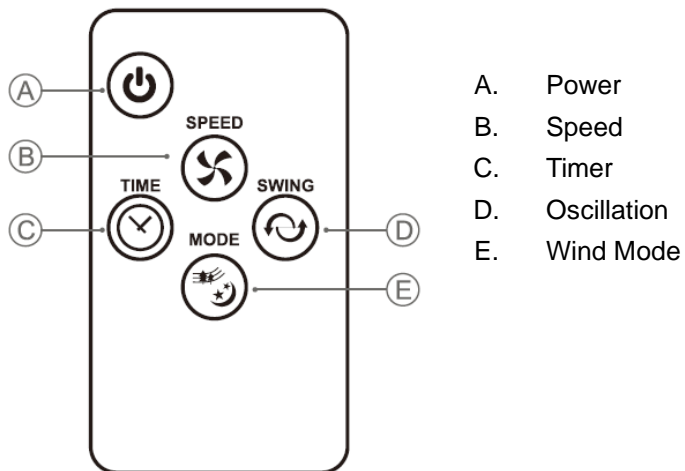
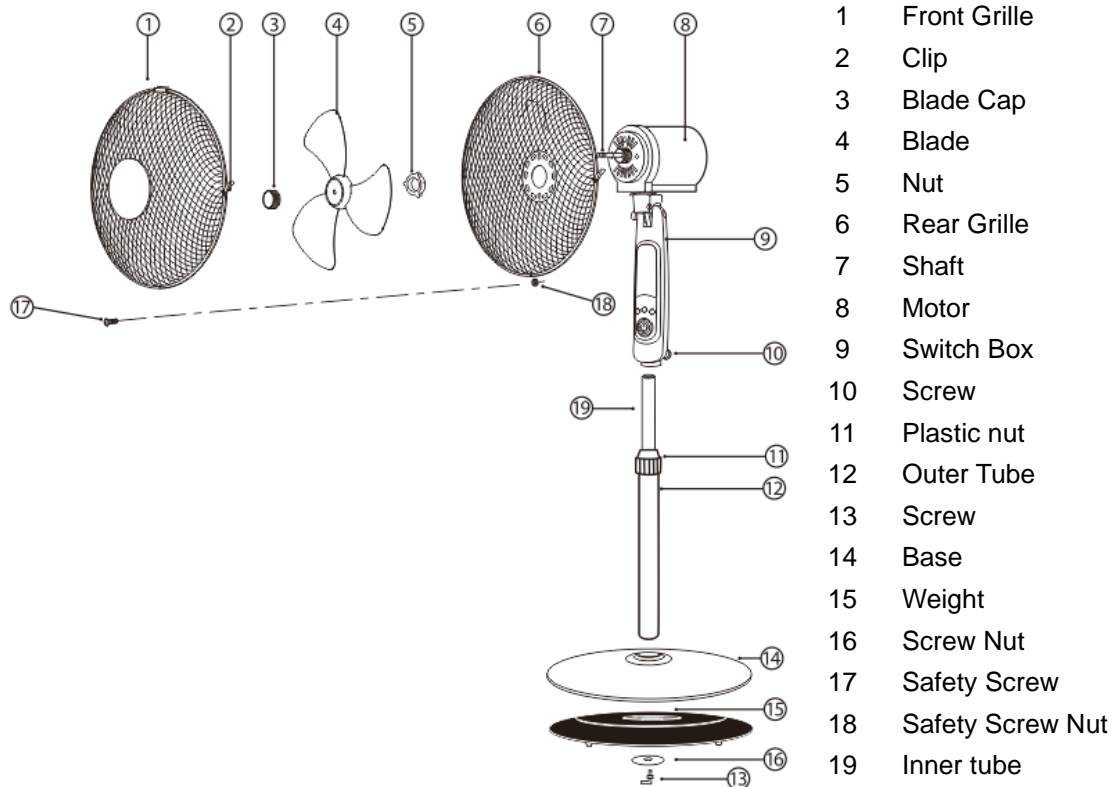

# REMOTE CONTROLLER

## ASSEMBLY

### 1. Base Assembly

Insert the bottom end of the pole into the centre hole of the base secured with 1 screw and 1 nut directly, no need any tool.

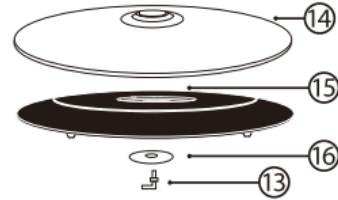

### 2. Fan Motor Assembly

Position the motor and switch box to the inner tube, secured with screw.

Screw the plastic nut tightly when adjust to the desire height.

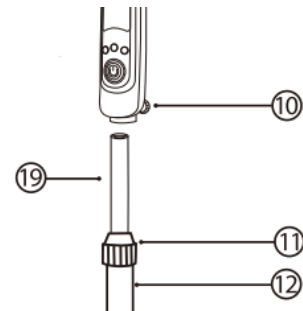

### 3. Rear Guard Assembly

Position the rear guard to the front motor housing. Turn the knob clockwise and tighten firmly.

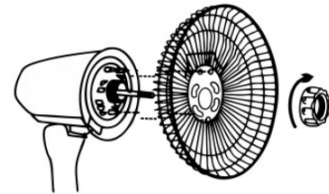

### 4. Fan Blade Assembly

Insert the fan blade to the motor shaft. Screw the blade anticlockwise to secure.

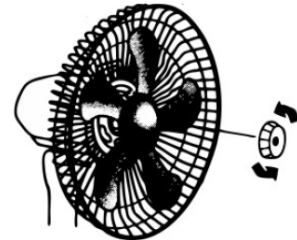

### 5. Front Guard Assembly

Secure both front and rear guard firmly by clips, make sure the safety screw is fixed with the nut.

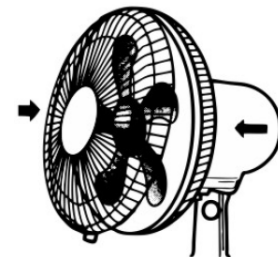

## USE

### 1. Speed control

Speed is controlled by pressing the SPEED button.

0 = Off, 1 = Low, 2 = Medium, 3 = High

### 2. Swing function

Press the swing button on the switch box, to activate the oscillation function for widespread breeze distribution. Press the button again to stop oscillation when the fan head is in the desired position.

### 3. Timer

Press the timer button to set the timer in increments of 0.5 hour to a maximum of 7.5 hours, each step is 0.5H.

### 4. Tilt adjusting

Air flow can be adjusted up or down, moving the fan's head up or down to the desired direction.

### 5. Height adjusting

From the extension pole loosen the height adjustment ring and slide the inner tube to the desired height. Once you have selected the desired height re-tighten it.

## REMOTE CONTROL

### 1. Mode

Press MODE on the remote control to change the fan mode through different breeze modes.



Note: SLEEP and NATURE function only can be controlled by remote control.

### 2. Fan Speed Adjustment

Press SPEED button to select LOW, MEDIUM or HIGH speed.

### 3. Swing Adjustment

Press the swing button, to activate the oscillation function for widespread breeze distribution. Press the button again to stop oscillation when the fan head is in the desired position

### 4. Timer Adjustment

Press the timer button to set the timer in increments of 0.5 hour to a maximum of 7.5 hours, each step is 0.5H.

## MAINTENANCE

1. Switch off and unplug from the power supply before assembling or disassembling and cleaning
2. Gently wipe the fan blade and grilles with a damp cloth. If the fan is very dirty use a wipe dry damp cloth. Do not use cleaning detergents, sprays or other chemicals, as they will damage the fan.
3. Store the fan in the original packing in a ventilated dry area.
4. The motor bearings are permanently sealed and do not require any additional lubrication.

## NOTICE ABOUT RECYCLING



Your product is designed and manufactured with high quality materials and components which can be recycled and reused.

This symbol means that electrical and electronic equipment, at their end-of-life, should be disposed of separately from your household waste. Please dispose of this equipment at your local community waste collection/ recycling centre. In the European Union there are separate collection systems for used electrical and electronic products.

Please help us to conserve the environment we live in!

## DECLARATION OF CONFORMITY

Herewith, we state that this product complies with the requirements of below directives:

EMC Directive 14/30/EU

Low Voltage Directive 14/35/EU

ErP Directive 09/125/EC

RoHS Directive 11/65/EU & 15/863/EU

CE-marking Directive 93/68/EEC



The detailed declaration of conformity can be found at

[www.united-electronics.gr](http://www.united-electronics.gr)

### **KALLIOPI KARYDA & CO LP**

87A, 17th November str, P.C. 55534

Thessaloniki – Greece

T: +302316006600 | F: +302316006650

[www.united-electronics.gr](http://www.united-electronics.gr)